

99354

Dimensions

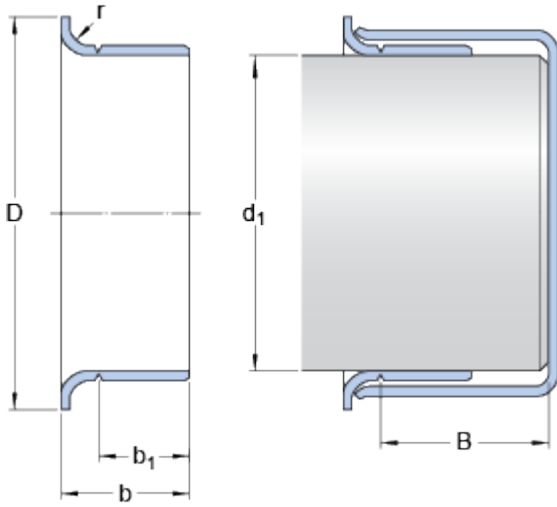

Nominal dimensions

d_1		90	mm
D		101.6	mm
Tolerance outside diameter D	\pm	1.6	mm
b		27.991	mm
Tolerance width b	\pm	0.8	mm
b_1		23.012	mm
Tolerance width b_1	\pm	0.8	mm
B	max.	44.45	mm
r	max.	3.18	mm

Shaft diameter range

d_1	min.	89.916	mm
d_1	max.	90.094	mm